

PATTON[®]

SOLUTIONS

From the leader in network access, connectivity, VoIP and mobile video-surveillance gear

BODi rS[™]

More Bandwidth. More Reliability. More Survivability.

BODi rS...for when Mobile
WAN Access is NOT optional



Providing high speed public Internet in mobile environments

Solution Overview

BODi rS is the perfect **B**andwidth **O**ptimization **D**evice with *reliable* and automatic **S**eamless failover for an enhanced mobile Internet experience for vehicles on the GO! BODi seamlessly aggregates and manages multiple ISP links, including satellite connections, ensuring broadband like speeds are always available to you. With up to four USB modem links bonded, the BODi enables users to make the most of their internet experience even at *highway speeds*.

In the event that Internet connections are lost, or links go down, end-user traffic is transparently and automatically routed across

other available wireless Internet connections. Connections of any type including 3G/4G/LTE/VSAT or WiFi. These redundant or complementary links are especially important when vehicles move in and out of rural areas or locations with weak signals.

All this means that when there is a glitch or failure in the network, your Internet service continues running smoothly, allowing you to continue enjoying broadband-like Internet speeds while on the go. This makes BODi rS the ideal solution for email, web-surfing, audio and even video streaming in a mobile environment.

Mobile installation made easy

Modem Bay: While most devices that connect with USB modems do so via an external port, the BD004 features an internal forced-air cooled bay that protects the modems from being inadvertently knocked off/and or damaged. By positively securing the modems

and providing the USB ports via cables, the BD004 exceeds the competition in resilience to shock and vibration in real world use cases.

And because cooling air is continually forced over the surface of your modems, the BD004 significantly extends the operational temperature range of your modems and the overall system. Tested for compatibility with more than 100 USB modems and more than 200 countries, no other USB cellular solution is more rugged, reliable, and available today.

Quick Power Connection: The BD004 comes with a terminal block for connecting to a DC power source. Simply strip the power harness wires, and insert them into the terminal block slots on the BODi rS BD004 rear panel.

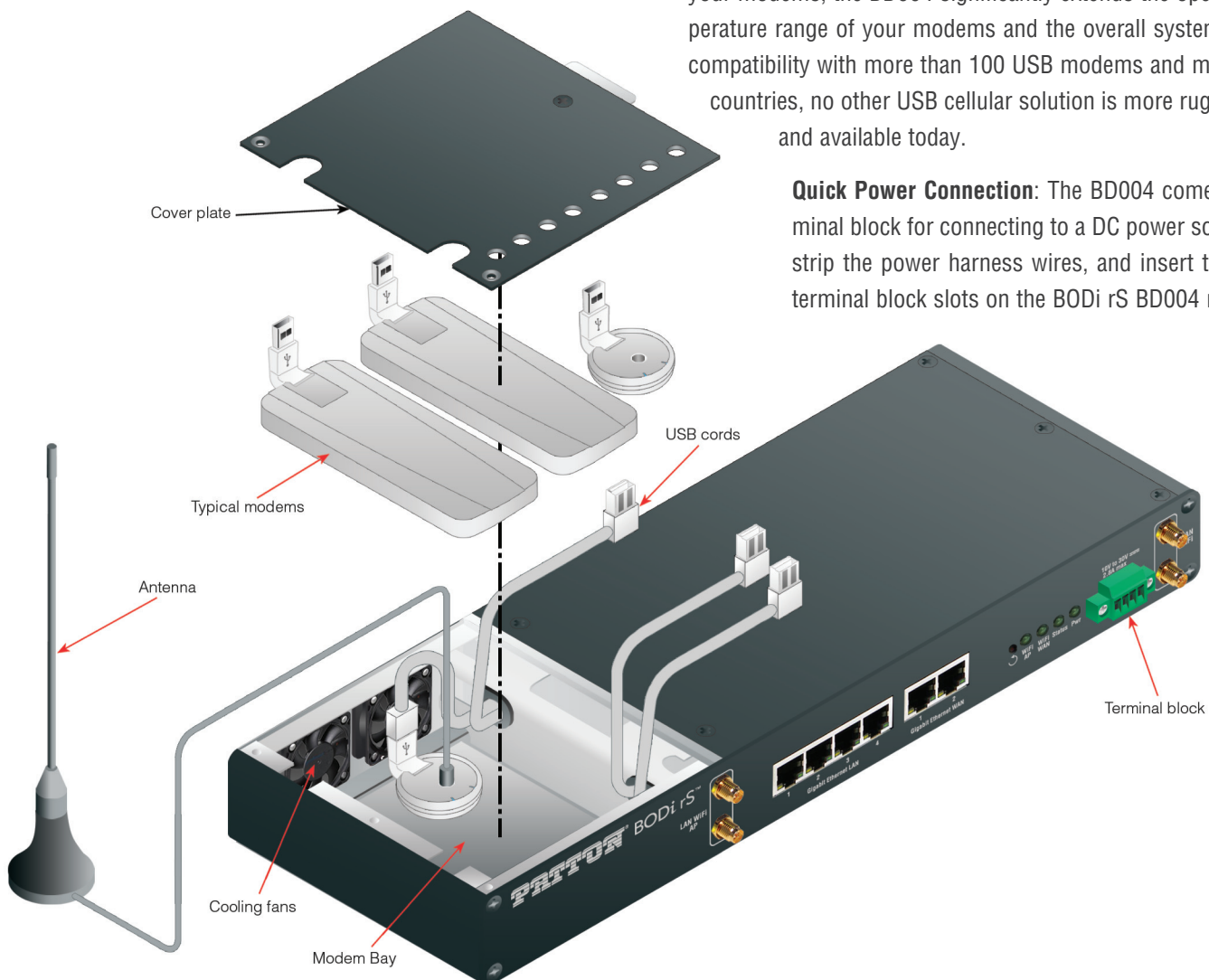

Best of both worlds: Bonding and Balancing

Bonding and balancing are the perfect solution for the mobile high speed internet experience. No matter the application your mobile users require, BODi's leading edge technologies of bonding and balancing enable you to achieve network application success. Bonding helps send your critical data securely (AES 256) as in any LAN-to-LAN VPN scenario. If your users need browsing, video streaming, or email they can simply access

the internet by sharing up to 7 different WAN link connections using a variety of built-in balancing algorithms to ease the need for complex configurations. Configure balancing for best effort network available for customer internet service, browsing, emails, and even skype. Configure bonding for best experience with seamless failover applications need for aggregated bandwidth and safely and securely passing your data.

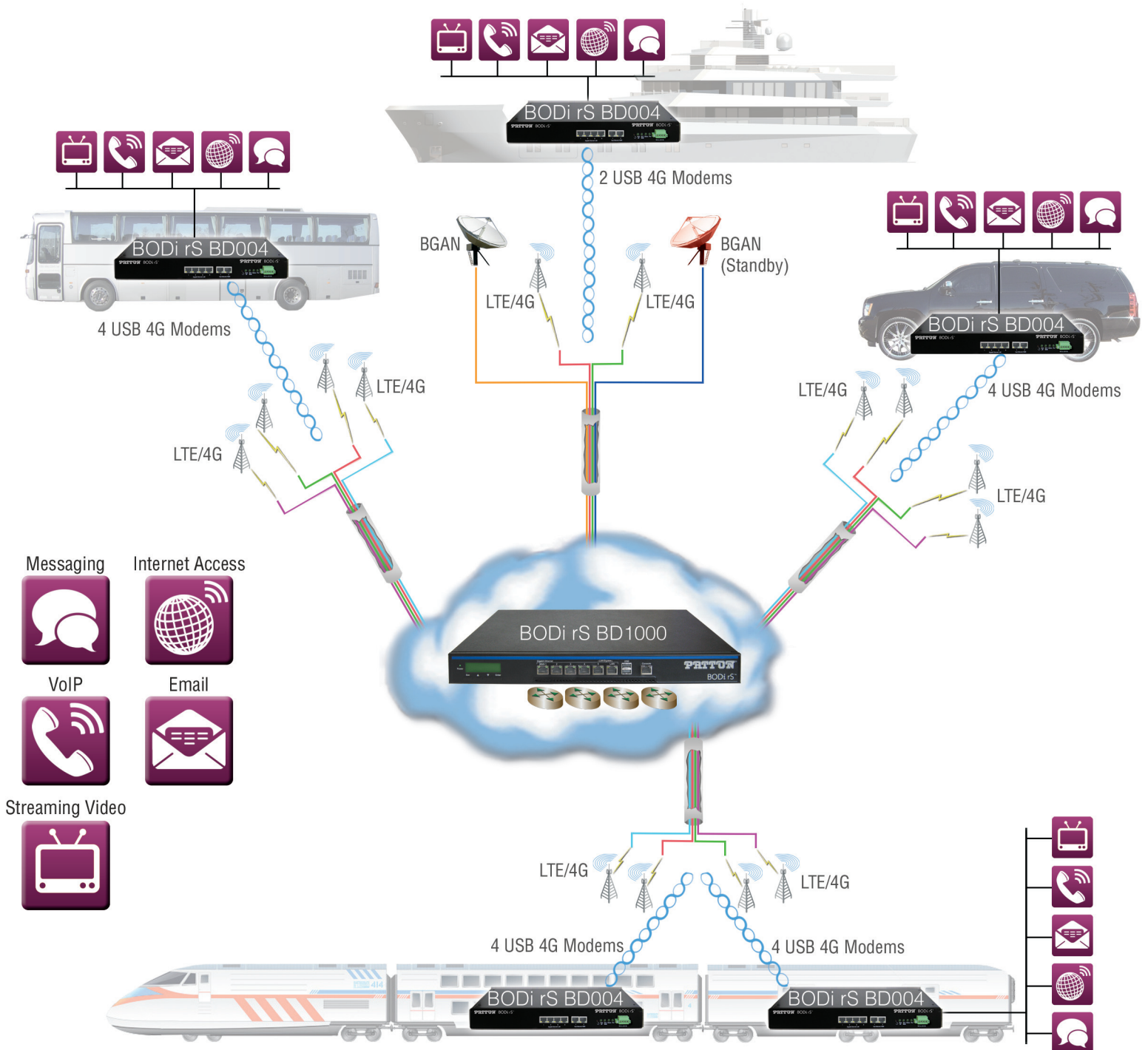

High Availability Fixed/Mobile Routers

Providing high speed public Internet in mobile environments

A Balanced solution

What you should know about a balanced aggregated solution:

Balancing is simple session-oriented load distribution to the cloud through as many as WAN interfaces as you have active. The BODi rS can be configured to dynamically make the correct decisions on every packet sent and the direction or path each packet is sent. The unique balancing suite of algorithms gives you the maximum bandwidth for your application scenarios.

- No pairs needed
- Aggregated by session-oriented packet distribution over all programmed WAN links.
- Balance up to 7 WAN interfaces using pre-configured balancing algorithms

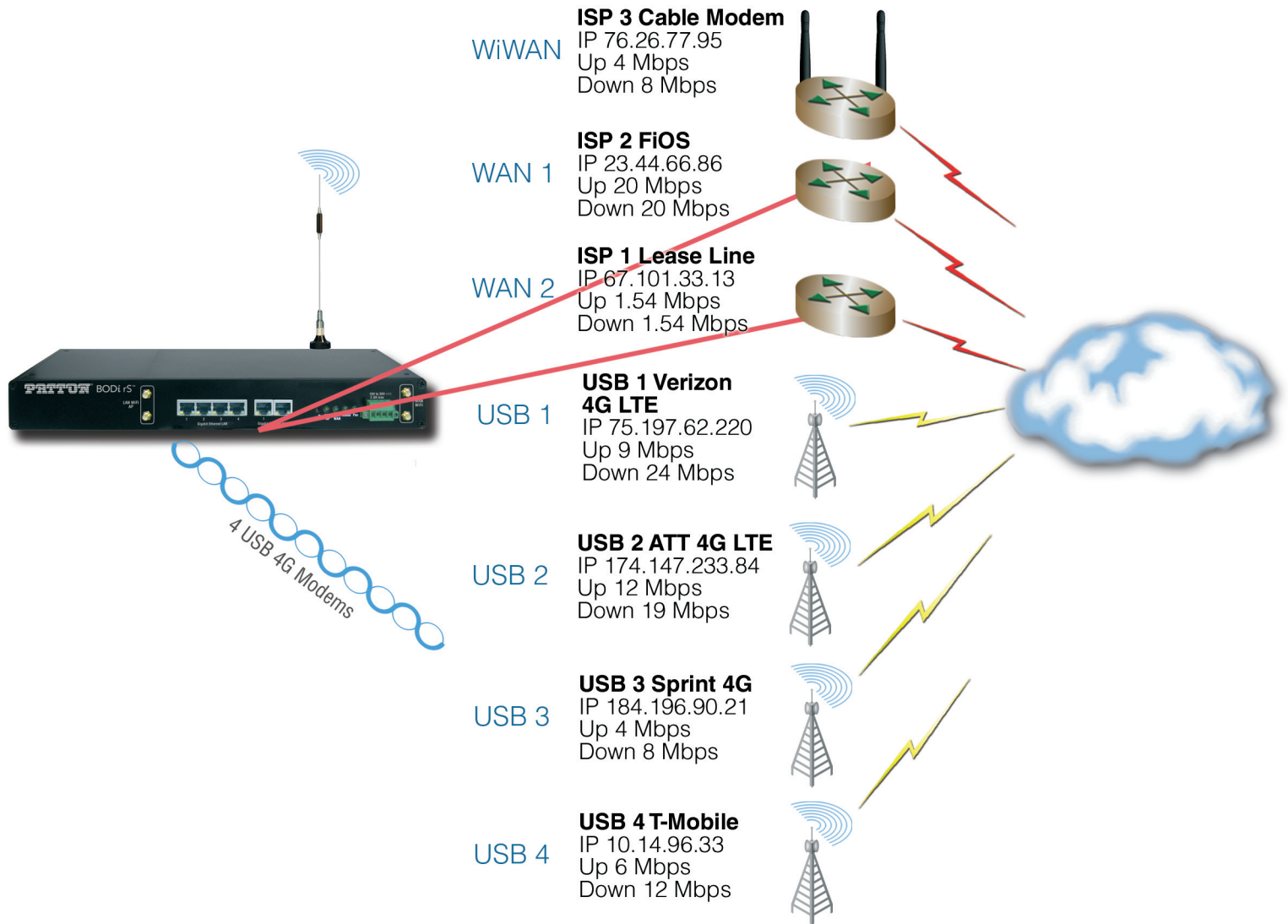

A Bonded solution

What you should know about a bonded transmission:

- Pairs (must have 2 BODi's)
- One global IP address

A WAN-Bonded Virtual Private Network (WBVPN) takes the traditional VPN model to another level by establishing the VPN tunnel over not

one WAN link, but multiple WAN links simultaneously. This bandwidth aggregation allows higher speed data rates than would be possible with a single link while greatly diminishing the VPN's vulnerability to link failures. Fast and reliable, WBVPN can be established over your wireless WAN links to offer complete control over remote units in mission critical network scenarios.

Solution Benefits

- Stable and constant Internet access
- Embedded WiFi modems allowing mobile users to easily connect and sync their smart devices
- Internal 3G/4G modems for security and protection—ensures modems stay safe and securely connected
- Bond multiple 3G/4G/LTE/Satellite modems for enhanced redundancy & connectivity, guaranteeing uptime
- Seamless and automatic failover ensuring you never loses Internet connectivity even if a connection to your ISP goes down
- Operates off of vehicle power
- Dynamically adjust profiles and configurations for optimum bandwidth performance
- Easily monitor and adjust usage policies depending on bandwidth and traffic
- Distribute and prioritize traffic for specific applications on selected links
- Prevent link saturation by low priority high bandwidth consumption traffic
- Intuitive user interface allowing for a quick and easy set up
- Full routing core including statefull firewall protection

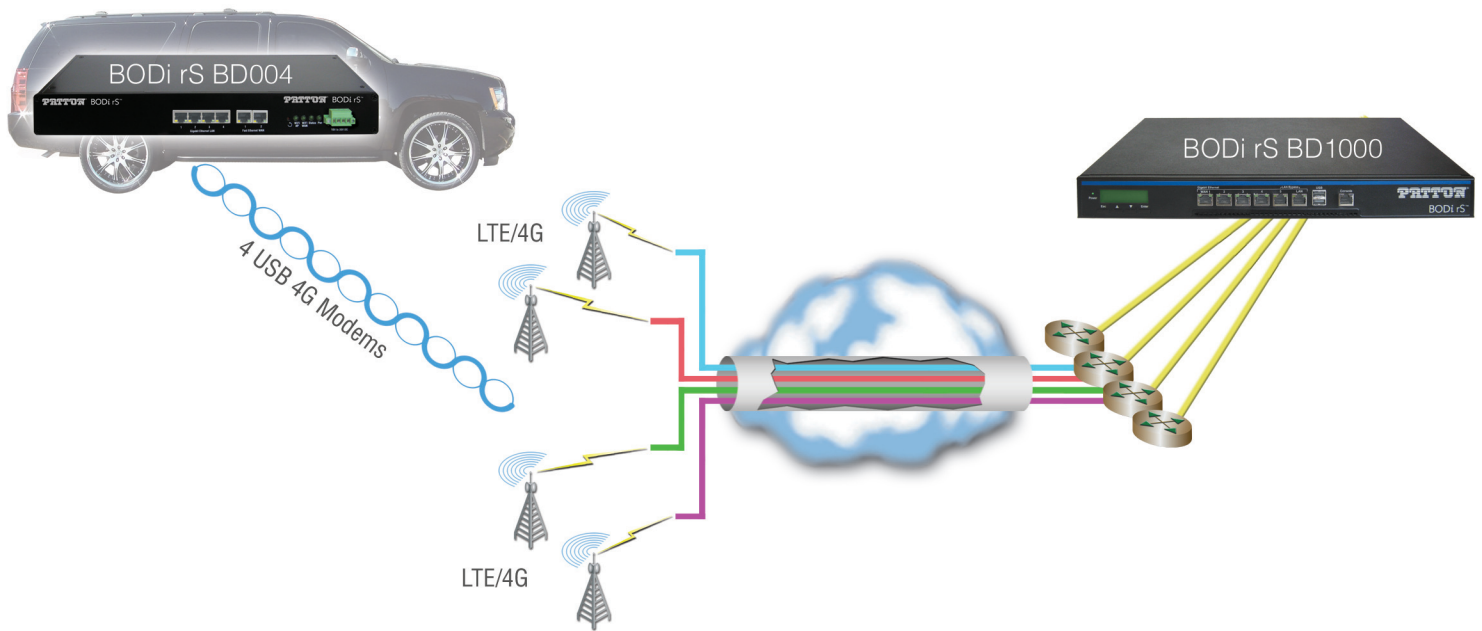

Conclusion

Whether you are providing online boarder protection for the United Nations in Turkey, Internet Access on luxury coaches, or secure voice/video/data services to a mobile command center, BODi rS is the right solution. With its intuitive web-based menus, vehicle-friendly enclo-

sure, and support for hundreds of modems around the world, BODi is also the easiest solution to deploy whether you're outfitting a single vehicle or hundreds. With Patton's BODi rS products, enterprise-grade quality, performance, security and reliability is yours, anywhere and anytime.

Your Patton solution starts here...





WiFi Router



Router



Switch



3G/4G Tower



WPN



BGAN

Ordering Info

- BODi rS BD007:** Enterprise Grade Bonding and Balancing Internet Router
- BODi rS BD007/R:** Rack Mountable Enterprise Grade Bonding and Balancing Internet Router
- BODi rS BD004:** Mobile, Bonding and Balancing Internet Router
- BODi rS BD1000:** Bandwidth-on-Demand Internet Network Appliance

www.patton.com

Patton Electronics Co.
7622 Rickenbacker Drive
Gaithersburg, Maryland 20879
USA
Phone +1 301 975 1000
Fax +1 301 869 9293
E-mail sales@patton.com

Patton-Inalp Networks AG
Meriedweg 7
CH-3172 Niederwangen
Switzerland
Phone +41 (31) 985 25 25
Fax +41 (31) 985 25 26
E-mail sales@inalp.com

Patton Hungary Zrt
Gábor Dénes utca 4.
Infopark Building C, Budapest H-1117
Hungary
Phone +36 1 439 4840
Fax +36 1 439 4844
E-mail ce@patton.com

